

File name C:\USERS\UKRVA001\WSP_036570113562 - HORNINGSEA GREENWAY DETAILED DESIGN - DOCUMENTS\03 WIP\CIVIL ENGINEERING\03 DRAWINGS\3562-WSP-HS-XX-DR-CV-100001.DWG, printed on 16 October 2023 15:46:25, by Vazquez Asenjo, Rodrigo

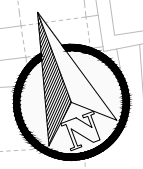
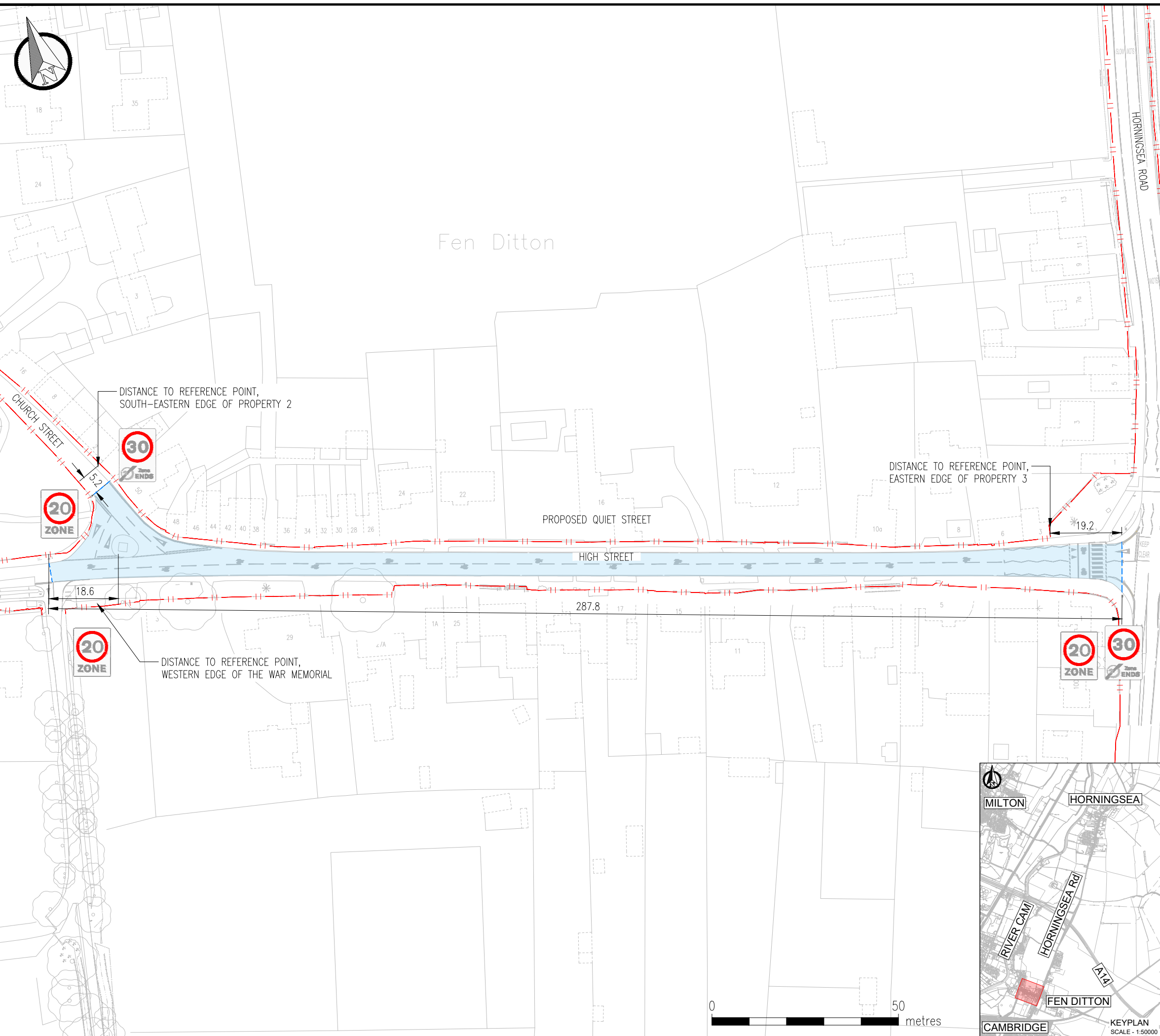

DO NOT SCALE

- KEY**
- EXTENTS OF PROPOSED 20 MPH ZONE
 - HIGHWAY BOUNDARY
 - LOCATION OF SPEED LIMIT SIGNS

- NOTES**
1. ALL DIMENSIONS IN METRES UNLESS OTHERWISE STATED

UNTIL TECHNICAL APPROVAL HAS BEEN OBTAINED FROM THE RELEVANT LOCAL AUTHORITIES OR STATUTORY BODIES, IT SHOULD BE UNDERSTOOD THAT ALL DRAWINGS ARE ISSUED AS PRELIMINARY AND NOT FOR CONSTRUCTION. SHOULD THE CONTRACTOR AND / OR EMPLOYER COMMENCE WORK PRIOR TO APPROVAL BEING GIVEN, IT IS ENTIRELY AT THEIR OWN RISK

P01	13/10/2023	CB	FIRST ISSUE		
REV	DATE	BY	DESCRIPTION	CHK	APP

DRAWING STATUS: **S2 - FOR INFORMATION**



62-64 Hills Road, Cambridge, CB2 1LA, UK
T+ 44 (0) 1223 558 050, F+ 44 (0) 1223 558 051
wsp.com



PROJECT: **HORNINGSEA GREENWAY DETAILED DESIGN**

TITLE: **TRAFFIC REGULATION ORDER PROPOSED 20MPH ZONE FEN DITTON HIGH STREET**

SCALE @ A3: 1:1000	CHECKED: RVA	APPROVED: ACC
PROJECT No: 70113562	DESIGNED: CB	DRAWN: CB
DRAWING No: 3562-WSP-HS-XX-DR-CV-100001		DATE: October 23
		REV: P01

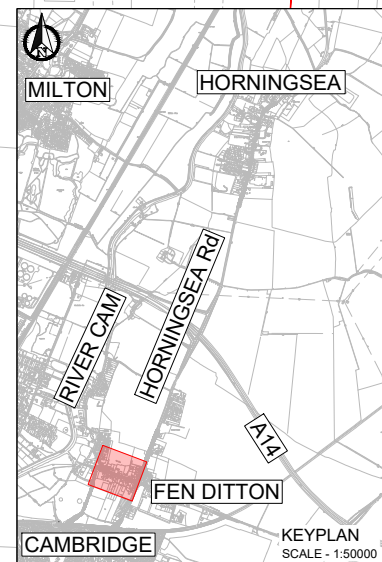

© WSP UK Ltd

File name C:\USERS\UKRVA001\WSP_0365701\3562 - HORNINGSEA GREENWAY DETAILED DESIGN - DOCUMENTS\03 WIP\CIVIL ENGINEERING\03 DRAWINGS\3562-WSP-HS-XX-DR-CV-100002.DWG, printed on 13 October 2023 17:06:05, by Vazquez, Asenjo, Rodrigo

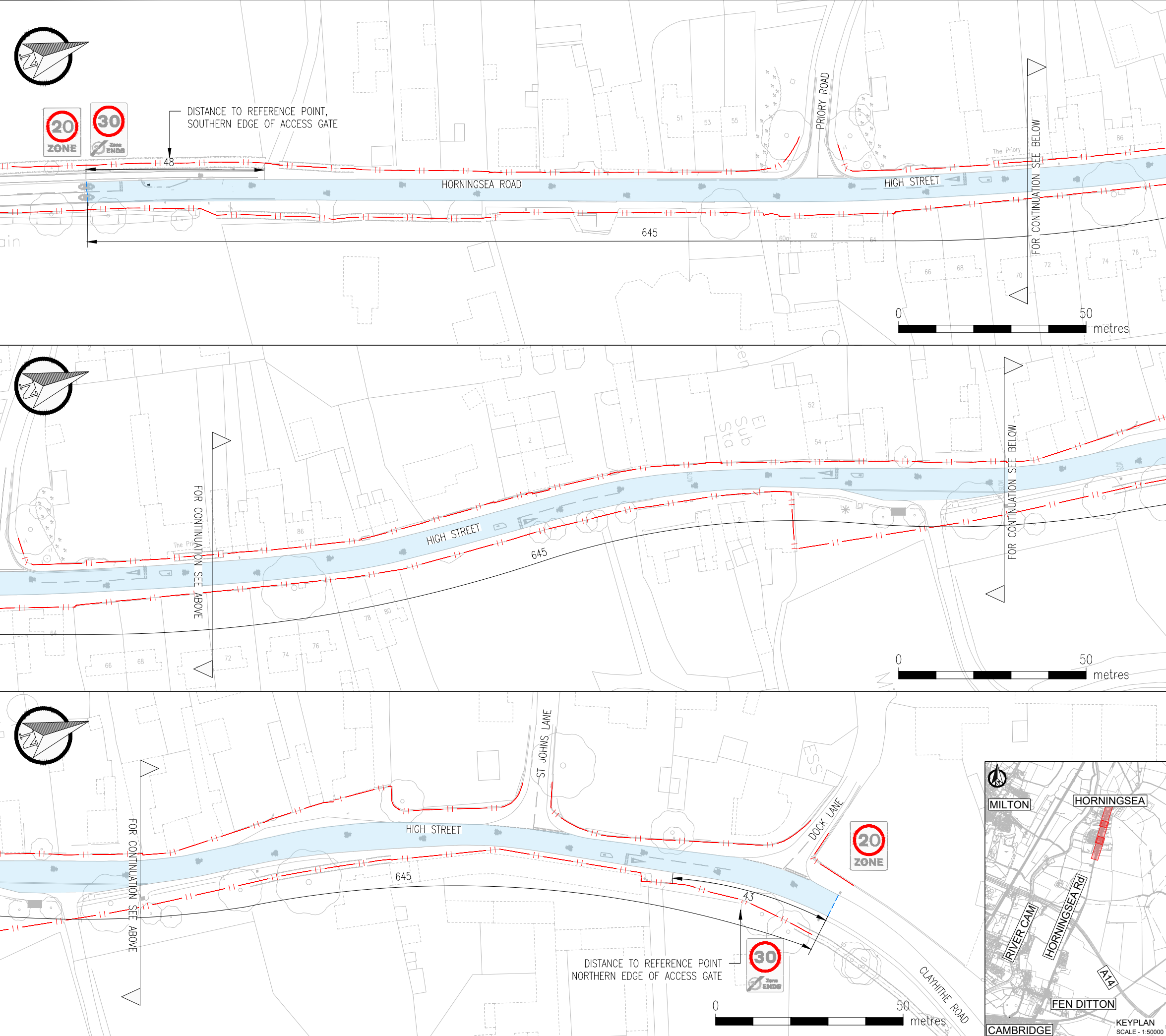

DO NOT SCALE

- KEY
- EXTENTS OF PROPOSED 20 MPH ZONE
 - HIGHWAY BOUNDARY
 - LOCATION OF SPEED LIMIT SIGNS

- NOTES
1. ALL DIMENSIONS IN METRES UNLESS OTHERWISE STATED

UNTIL TECHNICAL APPROVAL HAS BEEN OBTAINED FROM THE RELEVANT LOCAL AUTHORITIES OR STATUTORY BODIES, IT SHOULD BE UNDERSTOOD THAT ALL DRAWINGS ARE ISSUED AS PRELIMINARY AND NOT FOR CONSTRUCTION. SHOULD THE CONTRACTOR AND / OR EMPLOYER COMMENCE WORK PRIOR TO APPROVAL BEING GIVEN, IT IS ENTIRELY AT THEIR OWN RISK

P01	13/09/2023	CB	FIRST ISSUE		
REV	DATE	BY	DESCRIPTION	CHK	APP

DRAWING STATUS: **S2 - FOR INFORMATION**



62-64 Hills Road, Cambridge, CB2 1LA, UK
T+ 44 (0) 1223 558 050, F+ 44 (0) 1223 558 051
wsp.com



PROJECT: **HORNINGSEA GREENWAY DETAILED DESIGN**

TITLE: **TRAFFIC REGULATION ORDER PROPOSED 20MPH ZONE HORNINGSEA ROAD - HIGH STREET**

SCALE @ A3:	CHECKED:	APPROVED:
1:1000	RVA	ACC

PROJECT No:	DESIGNED:	DRAWN:	DATE:
70113562	CB	CB	October 23

DRAWING No:	REV:
3562-WSP-HS-XX-DR-CV-100002	P01



KEYPLAN SCALE - 1:50000

© WSP UK Ltd

File name C:\USERS\UKRVA001\WSP_036570113562 - HORNINGSEA GREENWAY DETAILED DESIGN - DOCUMENTS\03 WIP\CIVIL ENGINEERING\03 DRAWINGS\3562-WSP-HS-XX-DR-CV-100003.DWG, printed on 16 October 2023 15:19:24, by Vazquez Asenjo, Rodrigo

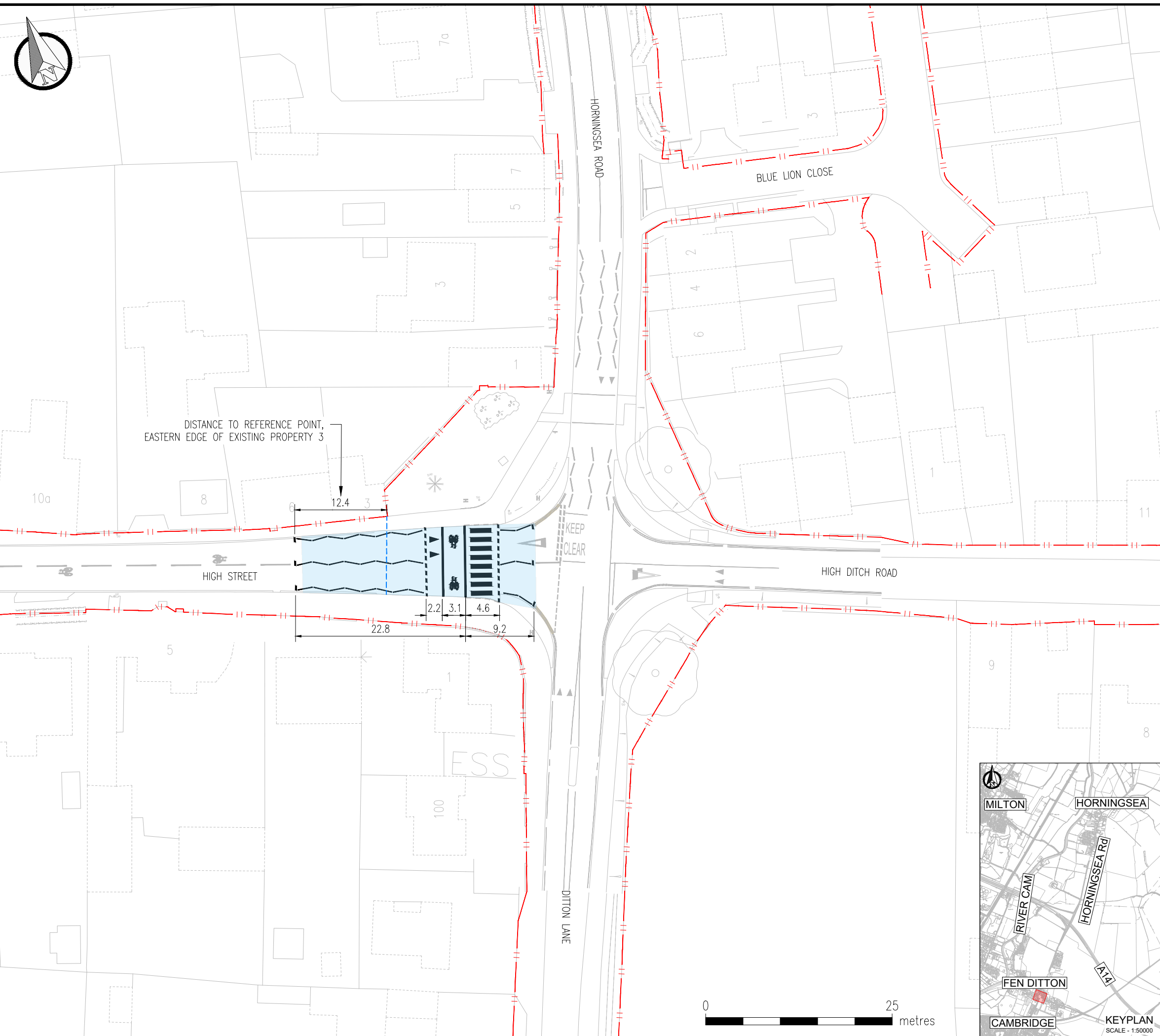

DISTANCE TO REFERENCE POINT,
EASTERN EDGE OF EXISTING PROPERTY 3

KEEP CLEAR

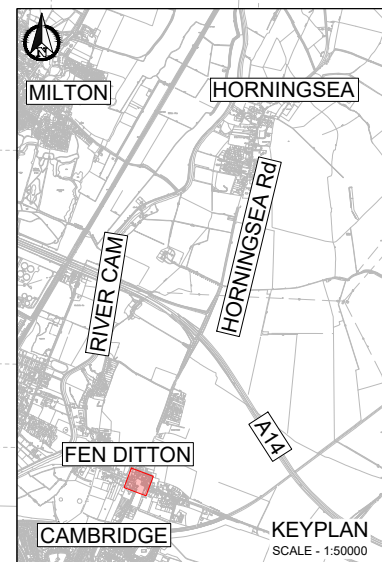

DO NOT SCALE

- KEY
- PROPOSED PARALLEL CROSSING LOCATION
 - HIGHWAY BOUNDARY
 - REFERENCE POINT LINE
 - PROPOSED PARALLEL CROSSING ROAD MARKINGS

- NOTES
1. ALL DIMENSIONS IN METRES UNLESS OTHERWISE STATED

UNTIL TECHNICAL APPROVAL HAS BEEN OBTAINED FROM THE RELEVANT LOCAL AUTHORITIES OR STATUTORY BODIES, IT SHOULD BE UNDERSTOOD THAT ALL DRAWINGS ARE ISSUED AS PRELIMINARY AND NOT FOR CONSTRUCTION. SHOULD THE CONTRACTOR AND / OR EMPLOYER COMMENCE WORK PRIOR TO APPROVAL BEING GIVEN, IT IS ENTIRELY AT THEIR OWN RISK

P01	13/09/2023	CB	FIRST ISSUE		
REV	DATE	BY	DESCRIPTION	CHK	APP

DRAWING STATUS: **S2 - FOR INFORMATION**

62-64 Hills Road, Cambridge, CB2 1LA, UK
T+ 44 (0) 1223 558 050, F+ 44 (0) 1223 558 051
wsp.com

**GREAT
CAMBRIDGE
PARTNERSHIP**

PROJECT: **HORNINGSEA GREENWAY DETAILED DESIGN**

TITLE: **TRAFFIC REGULATION ORDER
PROPOSED PARALLEL CROSSING
FEN DITTON**

SCALE @ A3: 1:500	CHECKED: RVA	APPROVED: ACC
PROJECT No: 70113562	DESIGNED: CB	DRAWN: CB
DRAWING No: 3562-WSP-HS-XX-DR-CV-100003		REV: P01

© WSP UK Ltd

File name C:\USERS\UKDB005\WSP_036570113562 - HORNINGSEA GREENWAY DETAILED DESIGN - DOCUMENTS\03 DRAWINGS\3562-WSP-HS-XX-DR-CV-100007.DWG, printed on 24 January 2024 17:08:42, by Bushell, Cameron

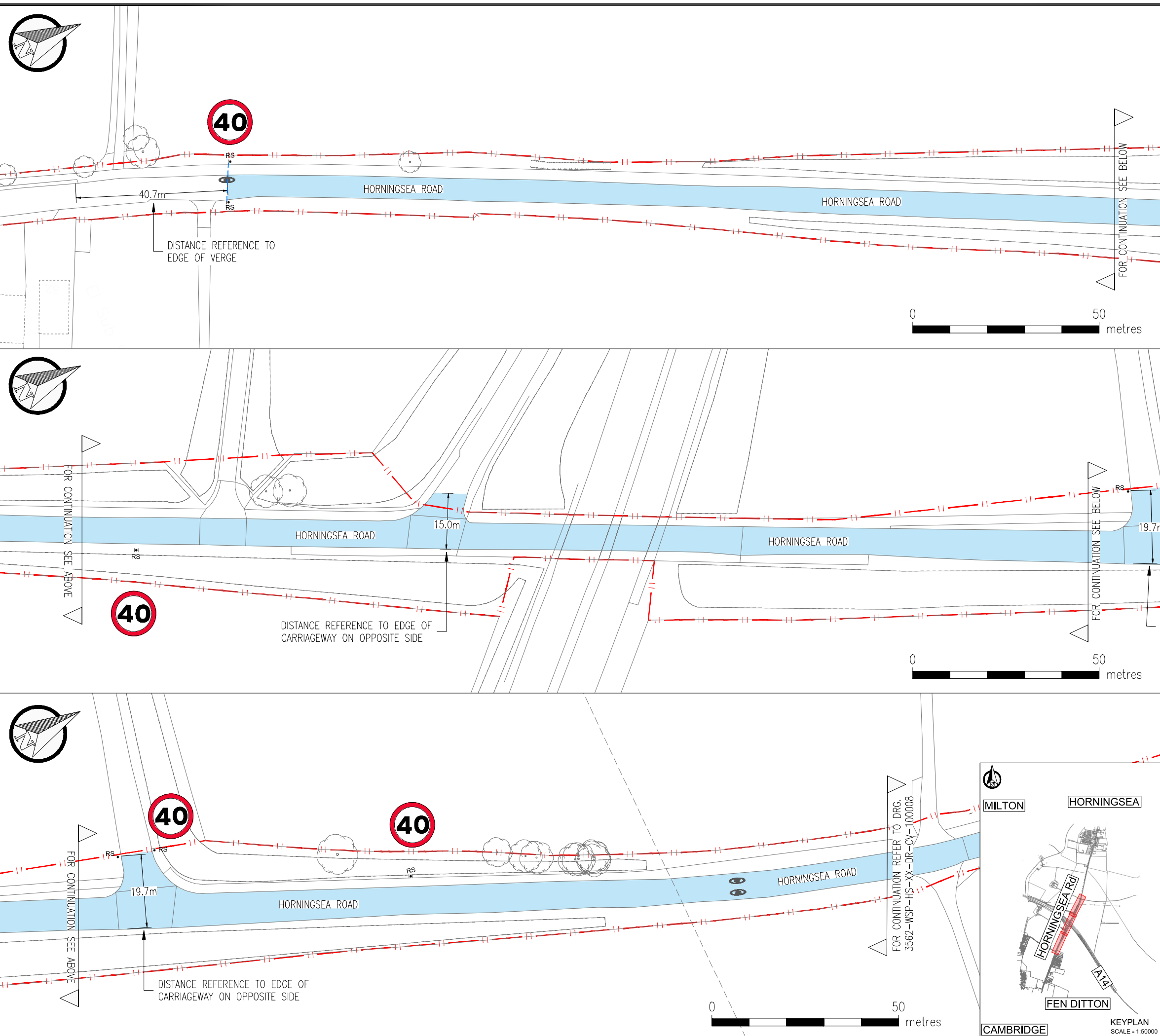

DO NOT SCALE

- KEY
- EXTENTS OF PROPOSED 40 MPH ZONE
 - HIGHWAY BOUNDARY
 - LOCATION OF SPEED LIMIT SIGNS

NOTES

- ALL DIMENSIONS IN METRES UNLESS OTHERWISE STATED

UNTIL TECHNICAL APPROVAL HAS BEEN OBTAINED FROM THE RELEVANT LOCAL AUTHORITIES OR STATUTORY BODIES, IT SHOULD BE UNDERSTOOD THAT ALL DRAWINGS ARE ISSUED AS PRELIMINARY AND NOT FOR CONSTRUCTION. SHOULD THE CONTRACTOR AND / OR EMPLOYER COMMENCE WORK PRIOR TO APPROVAL BEING GIVEN, IT IS ENTIRELY AT THEIR OWN RISK

P01	19/01/2024	CB	FIRST ISSUE		
REV	DATE	BY	DESCRIPTION	CHK	APP

DRAWING STATUS: **S4 - FOR APPROVAL**



62-64 Hills Road, Cambridge, CB2 1LA, UK
T+ 44 (0) 1223 558 050, F+ 44 (0) 1223 558 051
wsp.com



PROJECT: **HORNINGSEA GREENWAY DETAILED DESIGN**

TITLE: **TRAFFIC REGULATION ORDER PROPOSED 40MPH ZONE HORNINGSEA ROAD SHEET 01 OF 02**

SCALE @ A3: 1:1000	CHECKED: MS	APPROVED: ACC
PROJECT No: 70113562	DESIGNED: MILESTONE	DRAWN: CB
DRAWING No: 3562-WSP-HS-XX-DR-CV-100007		REV: P01

© WSP UK Ltd

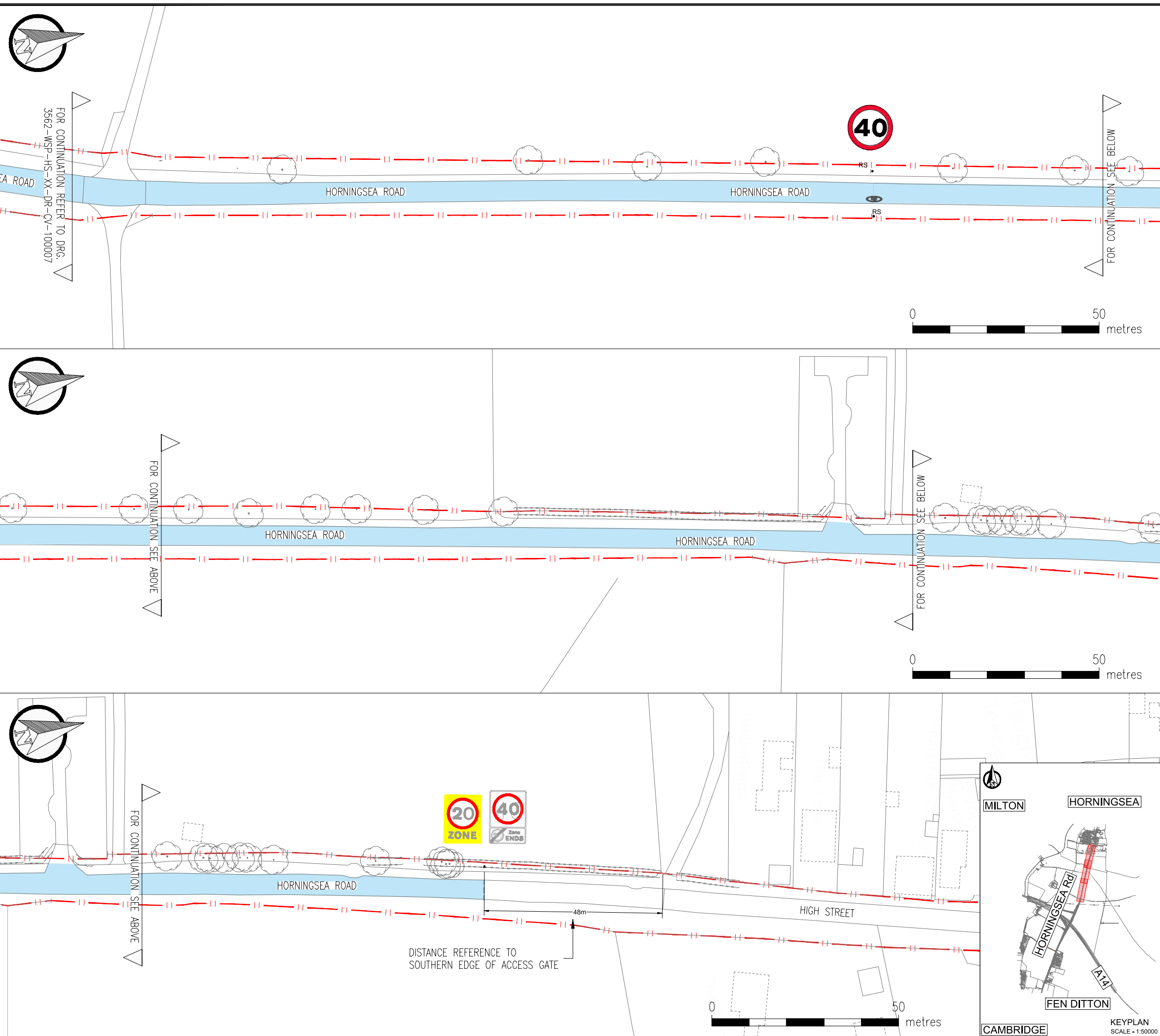

DO NOT SCALE

- KEY
- EXTENTS OF PROPOSED 40 MPH ZONE
 - HIGHWAY BOUNDARY
 - LOCATION OF SPEED LIMIT SIGNS

NOTES

- ALL DIMENSIONS IN METRES UNLESS OTHERWISE STATED

UNTIL TECHNICAL APPROVAL HAS BEEN OBTAINED FROM THE RELEVANT LOCAL AUTHORITIES OR STATUTORY BODIES, IT SHOULD BE UNDERSTOOD THAT ALL DRAWINGS ARE ISSUED AS PRELIMINARY AND NOT FOR CONSTRUCTION. SHOULD THE CONTRACTOR AND / OR EMPLOYER COMMENCE WORK PRIOR TO APPROVAL BEING GIVEN, IT IS ENTIRELY AT THEIR OWN RISK

P01	19/01/2024	CB	FIRST ISSUE		
REV	DATE	BY	DESCRIPTION	CHK	APP

DRAWING STATUS: **S4 - FOR APPROVAL**



62-64 Hills Road, Cambridge, CB2 1LA, UK
T+ 44 (0) 1223 558 050, F+ 44 (0) 1223 558 051
wsp.com



PROJECT: **HORNINGSEA GREENWAY DETAILED DESIGN**

TITLE: **TRAFFIC REGULATION ORDER PROPOSED 40MPH ZONE HORNINGSEA ROAD SHEET 02 OF 02**

SCALE @ A3: 1:1000	CHECKED: MS	APPROVED: ACC
-----------------------	----------------	------------------

PROJECT No: 70113562	DESIGNED: MILESTONE	DRAWN: CB	DATE: January 24
-------------------------	------------------------	--------------	---------------------

DRAWING No: 3562-WSP-HS-XX-DR-CV-100008	REV: P01
---	--------------------

© WSP UK Ltd

File name C:\USERS\UKCDB05\WSP_036570113562 - HORNINGSEA GREENWAY DETAILED DESIGN - DOCUMENTS\03 DRAWINGS\3562-WSP-HS-XX-DR-CV-100009.DWG, printed on 24 January 2024 17:04:21, by Bushell, Cameron

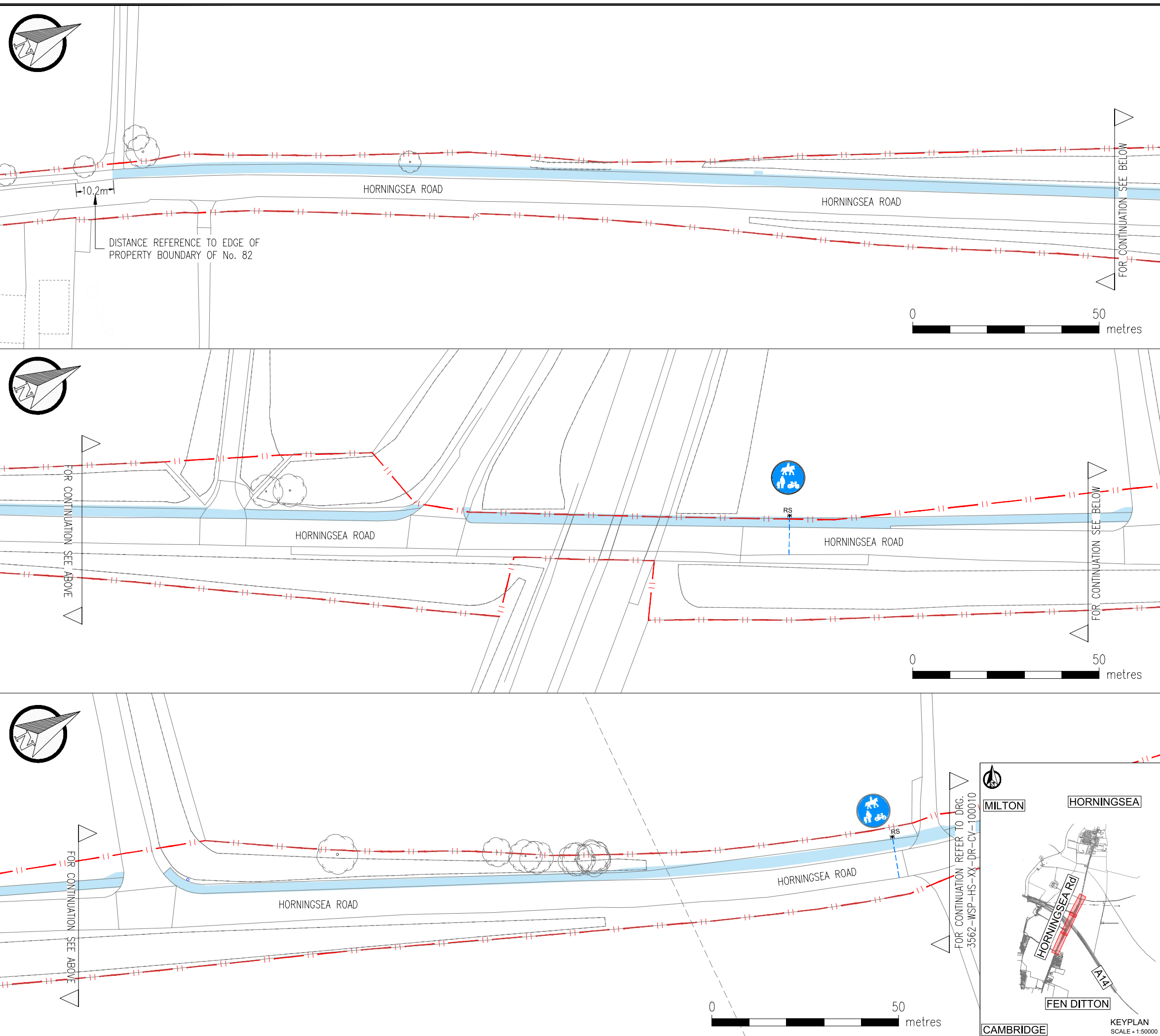

DO NOT SCALE

- KEY
- EXTENTS OF PROPOSED TRI-USER FACILITY
 - HIGHWAY BOUNDARY
 - LOCATION OF TRI-USER SIGNS

NOTES

- ALL DIMENSIONS IN METRES UNLESS OTHERWISE STATED

UNTIL TECHNICAL APPROVAL HAS BEEN OBTAINED FROM THE RELEVANT LOCAL AUTHORITIES OR STATUTORY BODIES, IT SHOULD BE UNDERSTOOD THAT ALL DRAWINGS ARE ISSUED AS PRELIMINARY AND NOT FOR CONSTRUCTION. SHOULD THE CONTRACTOR AND / OR EMPLOYER COMMENCE WORK PRIOR TO APPROVAL BEING GIVEN, IT IS ENTIRELY AT THEIR OWN RISK

P01	19/01/2024	CB	FIRST ISSUE		
REV	DATE	BY	DESCRIPTION	CHK	APP

DRAWING STATUS: **S4 - FOR APPROVAL**



62-64 Hills Road, Cambridge, CB2 1LA, UK
T+ 44 (0) 1223 558 050, F+ 44 (0) 1223 558 051
wsp.com



**GREAT
CAMBRIDGE
PARTNERSHIP**

PROJECT: **HORNINGSEA GREENWAY DETAILED DESIGN**

TITLE: **TRAFFIC REGULATION ORDER
PROPOSED TRI-USER FACILITY
HORNINGSEA ROAD
SHEET 01 OF 02**

SCALE @ A3: 1:1000	CHECKED: MS	APPROVED: ACC
PROJECT No: 70113562	DESIGNED: MILESTONE	DRAWN: CB
DRAWING No: 3562-WSP-HS-XX-DR-CV-100009		REV: P01

© WSP UK Ltd

File name C:\USERS\UKAXC082\WSP_0366570113562 - HORNINGSEA GREENWAY DETAILED DESIGN - DOCUMENTS\03 DRAWINGS\3562-WSP-HS-XX-DR-CV-100009.DWG, printed on 29 January 2024 14:55:41, by Calvo Cousins, Altana

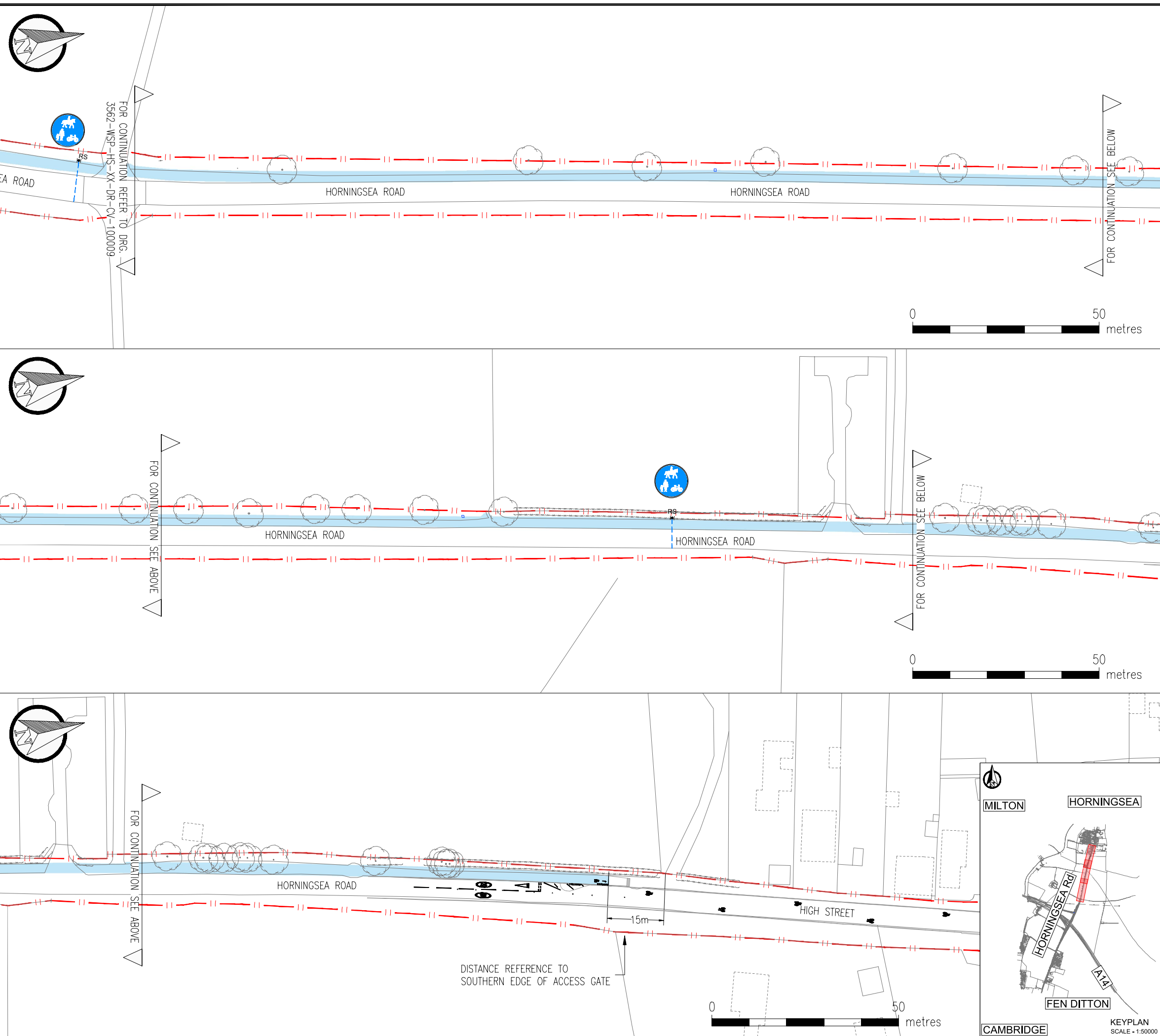

DO NOT SCALE

- KEY
- EXTENTS OF PROPOSED TRI-USER FACILITY
 - HIGHWAY BOUNDARY
 - LOCATION OF TRI-USER SIGNS

NOTES

- ALL DIMENSIONS IN METRES UNLESS OTHERWISE STATED

UNTIL TECHNICAL APPROVAL HAS BEEN OBTAINED FROM THE RELEVANT LOCAL AUTHORITIES OR STATUTORY BODIES, IT SHOULD BE UNDERSTOOD THAT ALL DRAWINGS ARE ISSUED AS PRELIMINARY AND NOT FOR CONSTRUCTION. SHOULD THE CONTRACTOR AND / OR EMPLOYER COMMENCE WORK PRIOR TO APPROVAL BEING GIVEN, IT IS ENTIRELY AT THEIR OWN RISK

P01	19/01/2024	CB	FIRST ISSUE		
REV	DATE	BY	DESCRIPTION	CHK	APP

DRAWING STATUS: **S4 - FOR APPROVAL**



62-64 Hills Road, Cambridge, CB2 1LA, UK
T+ 44 (0) 1223 558 050, F+ 44 (0) 1223 558 051
wsp.com



**GREATERT
CAMBRIDGE
PARTNERSHIP**

PROJECT: **HORNINGSEA GREENWAY DETAILED DESIGN**

TITLE: **TRAFFIC REGULATION ORDER PROPOSED TRI-USER FACILITY HORNINGSEA ROAD SHEET 02 OF 02**

SCALE @ A3: 1:1000 CHECKED: MS APPROVED: ACC

PROJECT No: 70113562 DESIGNED: MILESTONE DRAWN: CB DATE: January 24

DRAWING No: **3562-WSP-HS-XX-DR-CV-100010** REV: **P01**

© WSP UK Ltd